

FOR LEASE

Approx. 1,000 SqFt Office Building
with C-36 Zoned Yard / Parking Area



For more information contact:

Robbie Cornell
robbie@tollercornell.com
CA Lic # 01702034

Mick Toller
mick@tollercornell.com
CA Lic # 01355557

619-456-2380



TOLLER CORNELL
COMMERCIAL REAL ESTATE

The information contained herein has been obtained from sources we deem reliable. While we have no reason to doubt its accuracy, we do no guarantee it

FOR LEASE

Approx. 1,000 SqFt Office Building
with C-36 Zoned Yard / Parking Area

- Property Type:** Quality freestanding office Building with yard / parking area.
- Office Area:** Fully Furnished office area, Reception, 3 to 4 Desk locations, Conference area 1 restrooms
- Zoning:** County of San Diego C-36 zoning
- Location:** Exit Los Coches Road off Highway 8. Head North then turn right on Highway 8 Business. Head East on Highway 8 Business and turn right Kay Jay Lane.
- Lease Rate:** \$6,900 per month plus utilities



13606 Highway 8 Business, Lakeside, CA 92040

For more information contact:

Robbie Cornell
robbie@tollercornell.com
CA Lic # 01702034

Mick Toller
mick@tollercornell.com
CA Lic # 01355557

619-456-2380



TOLLER CORNELL
COMMERCIAL REAL ESTATE

FOR LEASE

Approx. 1,000 SqFt Office Building with C-36 Zoned Yard / Parking Area

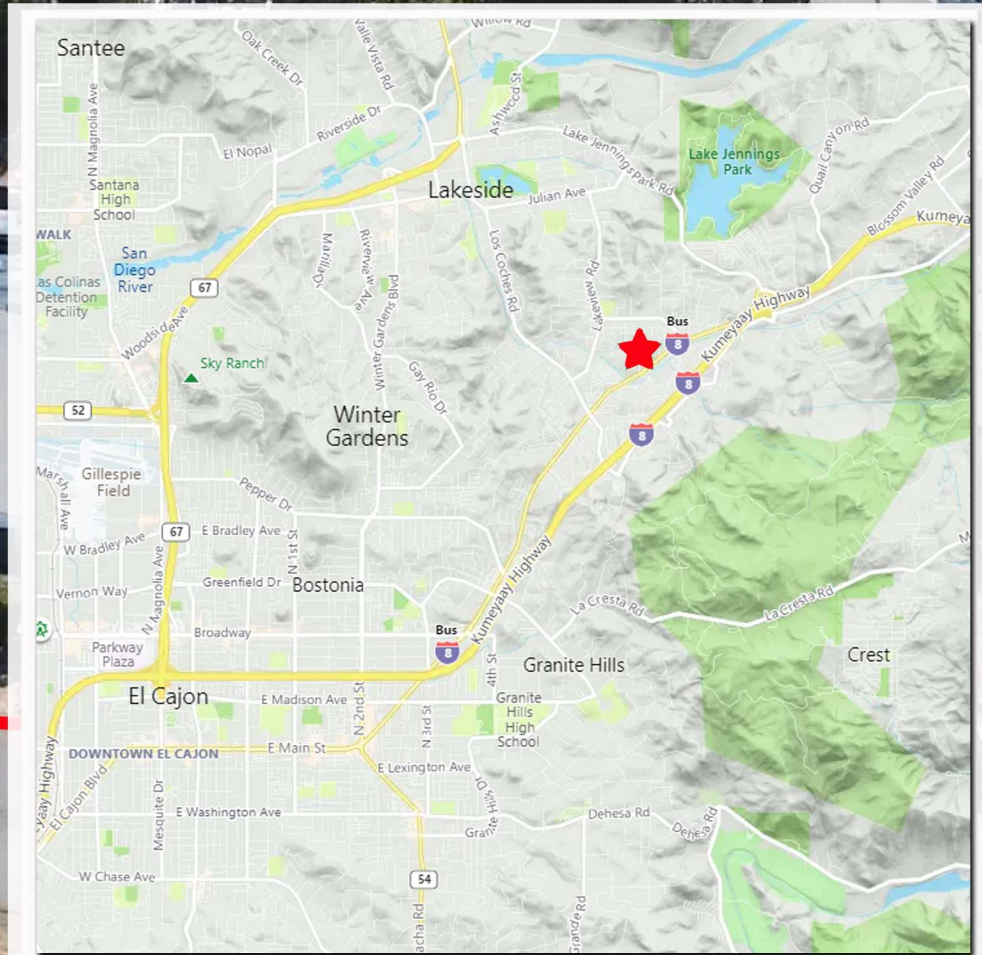

13606 Highway 8 Business, Lakeside, CA 92040

For more information contact:

Robbie Cornell
robbie@tollercornell.com
CA Lic # 01702034

Mick Toller
mick@tollercornell.com
CA Lic # 01355557

619-456-2380



TOLLER CORNELL
COMMERCIAL REAL ESTATE