

For Lease

48,792 SF Multi-Tenant Industrial 3,041 SF Available



10050 Marathon Pkwy, Lakeside, CA

For more information contact:

Robbie Cornell
robbie@tollercornell.com
CA Lic # 01702034

Mick Toller
mick@tollercornell.com
CA Lic # 01355557

619-456-2380



TOLLER CORNELL
COMMERCIAL REAL ESTATE

The information contained herein has been obtained from sources we deem reliable. While we have no reason to doubt its accuracy, we do no guarantee it

For Lease

48,792 SF Multi-Tenant Industrial 3,041 SF Available

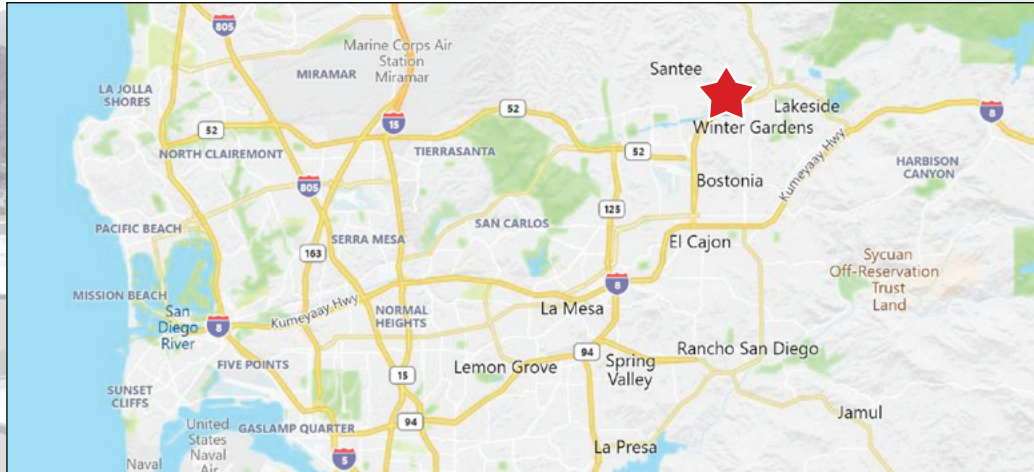

DRIVE TIME MATRIX

Kearny Mesa	16.3 mi, 19 mins
National City	20.0 mi, 25 mins
Miramar	18.6 mi, 21 mins
Otay Mesa	27.5 mi, 33 mins
Poway	14.9 mi, 23 mins
Escondido	33.0 mi, 39 mins
Carlsbad	41.3 mi, 45 mins

New Concrete Tilt-Up
Construction

Concrete Driveways

ESFR Sprinkler System

24' Warehouse Clear Height

12' X 14' Roll Doors

200 amps | 120/208v | 3 Phase
Power Per Suite

3.3 / 1000 Parking Ratio

Common Double Dock Well

\$0.35 NNN

\$1.50 PSF/NNN

For more information contact:

Robbie Cornell
robbie@tollercornell.com
CA Lic # 01702034

Mick Toller
mick@tollercornell.com
CA Lic # 01355557

619-456-2380



TOLLER CORNELL
COMMERCIAL REAL ESTATE

For Lease

48,792 SF Multi-Tenant Industrial 3,041 SF Available

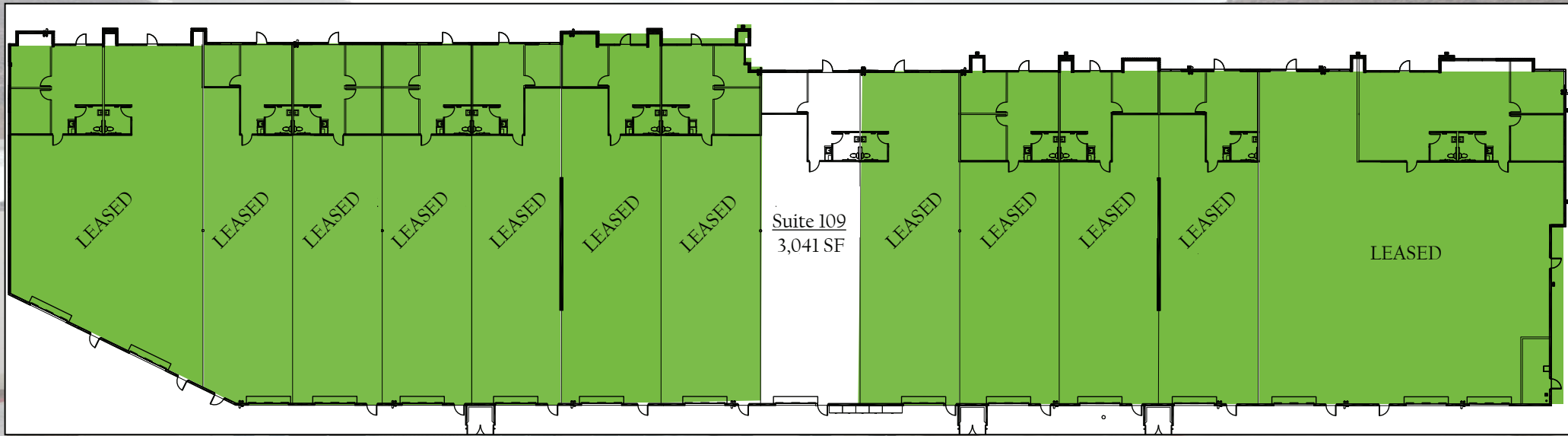

AVAILABILITIES

SUITE	SF	DESCRIPTION	AVAILABLE
109	3,041	Reception, 1 private office, 1 restroom, coffee bar	7/15/2025

For more information contact:

Robbie Cornell
robbie@tollercornell.com
CA Lic # 01702034

Mick Toller
mick@tollercornell.com
CA Lic # 01355557

619-456-2380



TOLLER CORNELL
COMMERCIAL REAL ESTATE

The information contained herein has been obtained from sources we deem reliable. While we have no reason to doubt its accuracy, we do no guarantee it

For Lease

48,792 SF Multi-Tenant Industrial 3,041 SF Available

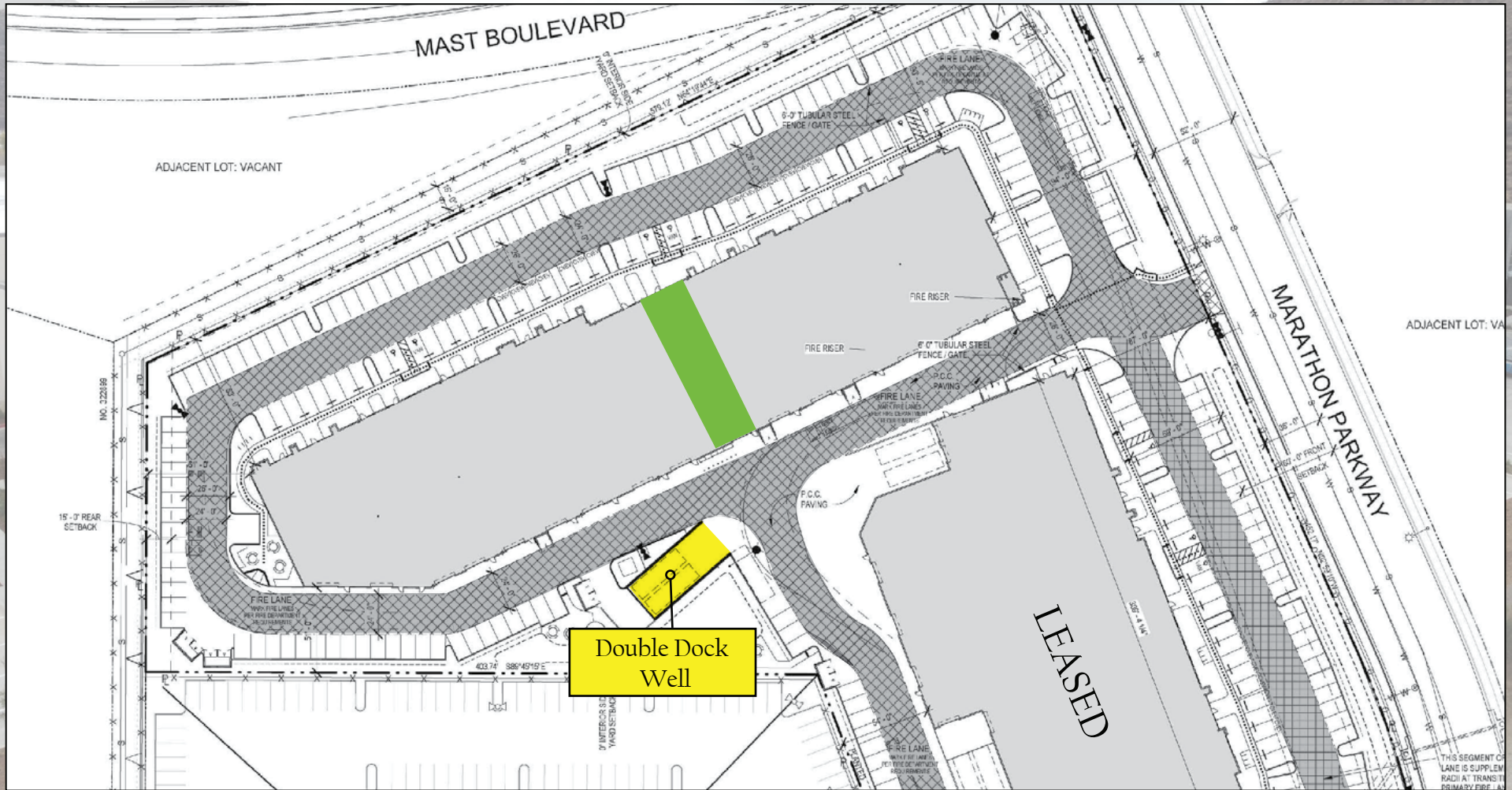

For more information contact:

Robbie Cornell
robbie@tollercornell.com
CA Lic # 01702034

Mick Toller
mick@tollercornell.com
CA Lic # 01355557

619-456-2380



TOLLER CORNELL
COMMERCIAL REAL ESTATE

The information contained herein has been obtained from sources we deem reliable. While we have no reason to doubt its accuracy, we do no guarantee it